



11, Goldsmith House Shakespeare Road, London, W3 6SH

A bright top floor two-bedroom purpose built apartment, part of this small development on Shakespeare Road. Situated in a prime spot, ready to take advantage of all Acton's Poet Corner has to offer.

The property provides good sized accommodation and comes in immaculate condition .

This a perfect opportunity for a first-time buyer or someone looking to downsize and to purchase a great property in a central location with no renovation work required.

£450,000

- Purpose built
- Two bedrooms
- Share of freehold
- Top floor
- Immaculate condition
- Communal gardens
- Close to Churchfield Road
- Heart of Poets' Corner
- Elizabeth line nearby

Goldsmith House

Approximate Gross Internal Area
635 sq ft - 59 sq m

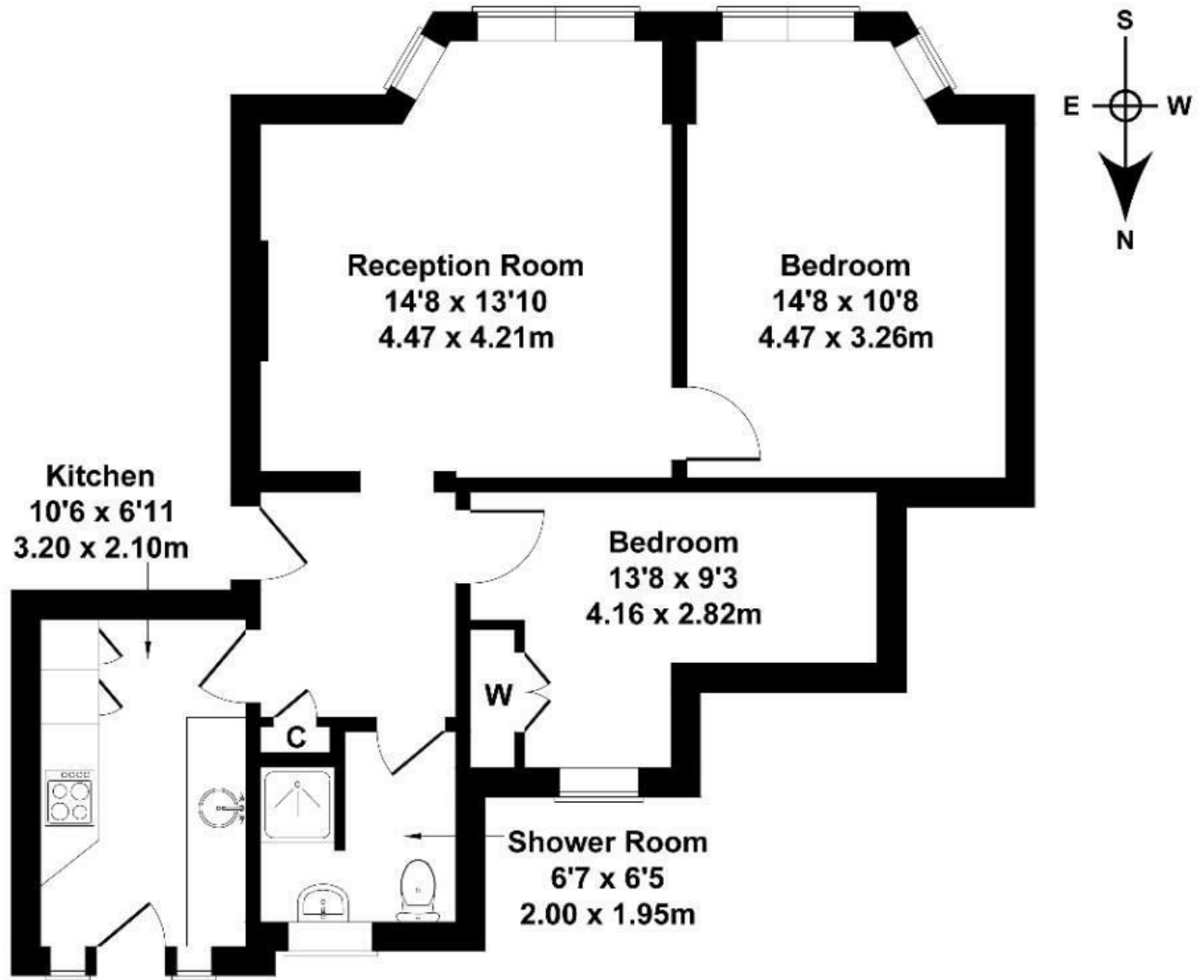

SECOND FLOOR

Not to Scale. Produced by The Plan Portal 2023
For Illustrative Purposes Only.

Energy Efficiency Rating		
	Current	Potential
<i>Very energy efficient - lower running costs</i>		
(92 plus) A		
(81-91) B		
(69-80) C		
(55-68) D		
(39-54) E		
(21-38) F		
(1-20) G		
<i>Not energy efficient - higher running costs</i>		
England & Wales	EU Directive 2002/91/EC	